



Noah

User Guide

Protect and monitor the things you love

Contents

Meet Noah	2
Noah for your home	4
Download app	5
Setting up Noah	10
Arming and disarming Noah	16
How to use the Noah hub	17
Installing Noah hub on a wall	18
Adding sensors	19
Settings	28

Struggling to read?

View this start up guide online at
time2technology.com/manuals

Meet Noah



Noah Hub

This is the hub for your Noah Alarm System. It connects all your accessories to the Clan at Home app so you can secure your home from anywhere, at any time.

Connects to mains power supply using the cable and adapter provided

Remote Control

The lightweight and compact remote control is designed to fit easily onto a keychain or in your pocket.

The remote control can be used to arm or disarm the Noah Alarm System or even trigger the SOS emergency alarm.





Door/Window Sensor

The sensor can be installed on doors, windows and even cupboards.

The sensor transmits a signal to the Noah Hub and triggers an alarm when the door or window is opened.

Motion Sensor

The sensor detects indoor human movement.

The sensor transmits a signal to the Noah Hub and triggers an alarm whenever unusual movement has been detected



Noah for your home

The image below shows how a Noah Alarm System can be set up in your home. You can customise the setup to meet your own requirements by adding additional sensors and accessories.

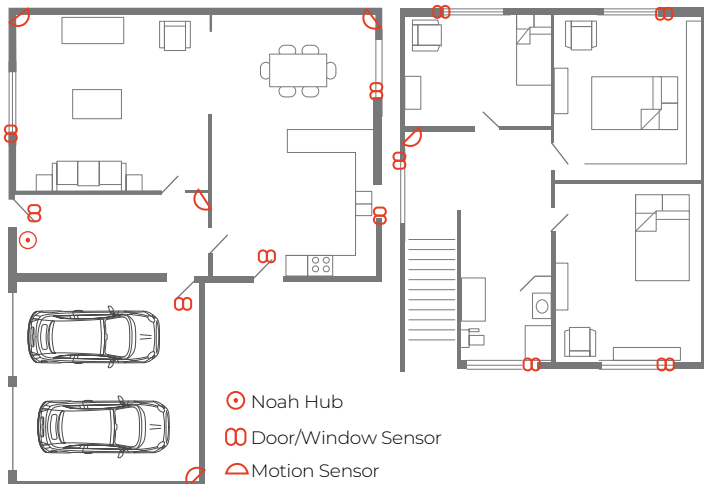

Download App

Download the “Clan at Home” app from the iOS App Store or Google Play Store

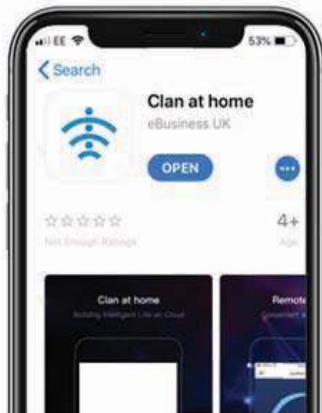
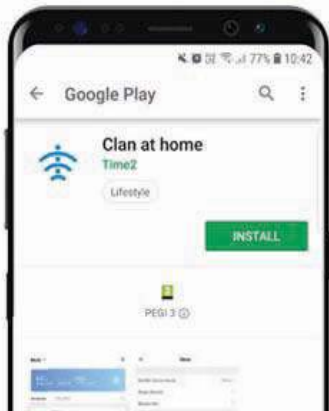

Register your Clan account

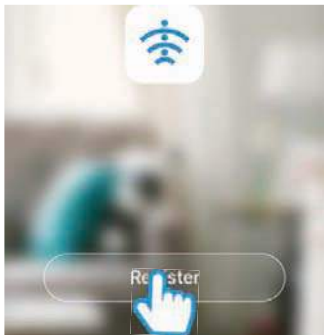

Step 1

Open the app then press Register

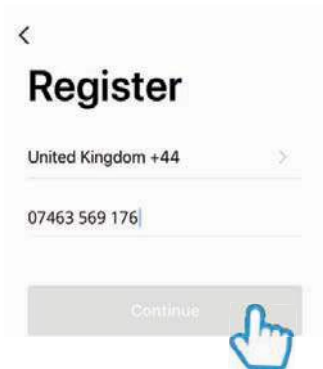

Step 2

Enter your mobile phone number
or email address

Please ensure you enter your
full phone number including "0"



Step 3

Enter the verification code sent via SMS or email

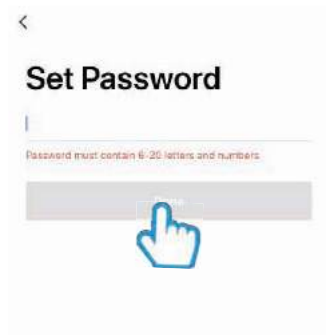

Step 4

Create your password to login

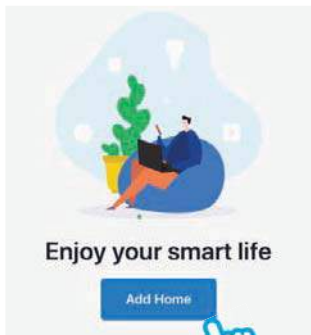

Step 5

Press "Add Home"



Step 6

Enter a name for your home and select location

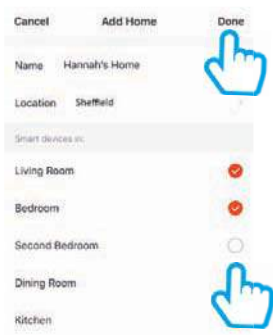

Step 7

Select rooms you have in your home, then press done to save

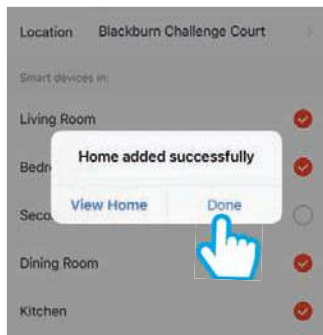

Step 8

Once complete, press Done.
Your Clan account has been created successfully."

Setting up Noah

1. Power the Noah hub to the mains using the power adapter and micro USB cable provided
2. Remove the back cover from the hub by rotating it anti-clockwise
3. Use the on/off switch at the back of the hub to switch on

The hub will make a beeping sound and flash red when it is ready to connect

4. Replace the back cover of the Noah hub

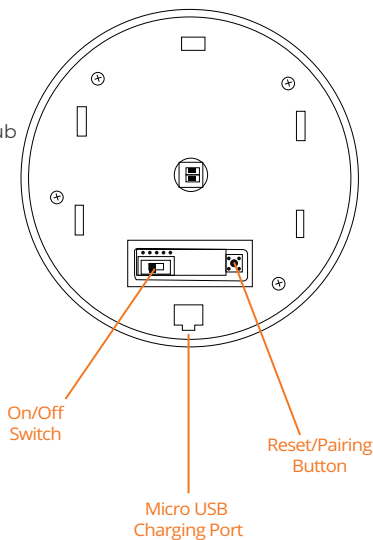

Connect Noah to the Clan app

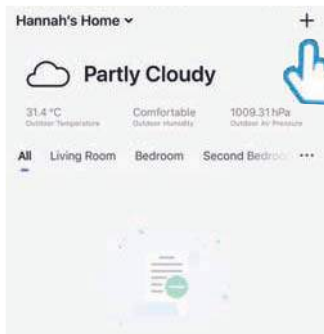

Step 1

In My Home, press the (+) icon in the top right corner of the screen



Step 2

Press Other

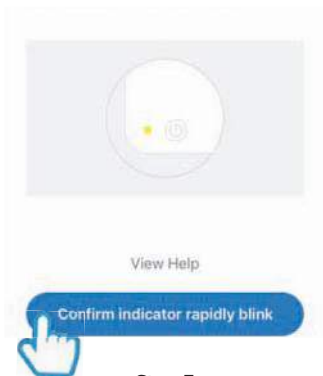

Step 3

Make sure the Noah hub is flashing red. If it is not flashing, please ensure the hub has been switched on

Press Confirm Indicator
Rapidly Blinking

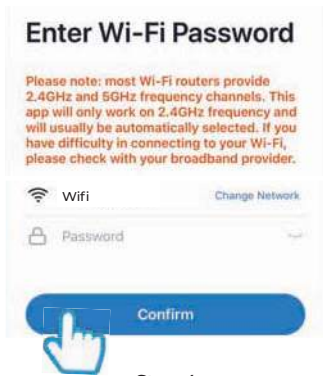

Step 4

Enter your WiFi router password
Then press Confirm

Connecting Now



Ensure that your Phone and Device are as close to your WIFI router as possible.



Step 5

The Noah hub will then establish a connection to Clan

Device added successfully

 **Noah Alarm System** 

Main Office

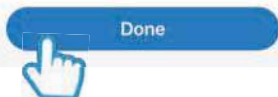

Step 6

Once connected, you can change Noah's name and select the room he is in.

Press Done. Noah is now connected to the Clan app.

Dashboard

Once Noah has been connected to your app, the Noah dashboard will be displayed

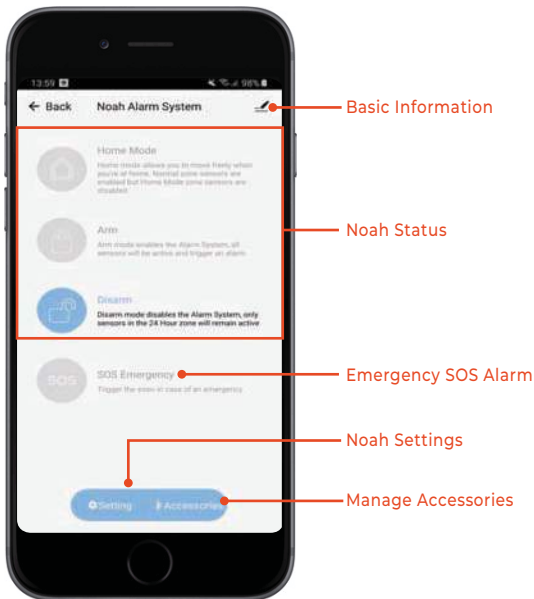

The Noah Alarm System has three security modes and an emergency SOS button.

Arm

 Arm Noah when leaving your home. All sensors will be activated. Any sensors that are triggered will immediately sound the alarm

Disarm

 Disarm Noah when entering your home. All sensors will be deactivated allowing you to move freely

Home Mode

 Sensors that are designated in the Home Zone are deactivated, allowing you to move freely in your home. The sensors in Normal Zone will remain active and if triggered, will immediately sound the alarm (See page 25 - Manage zones)

Emergency Call

 Press the SOS button in the event of an emergency. This will trigger an immediate alarm even if Noah is disarmed or in Home Mode. To stop the alarm, press the disarm button on the app or remote control

Arming and Disarming Noah

You can arm, disarm and switch between security modes using:

1. Clan at Home App
2. Remote Control
3. Touch keypad on Noah hub (arming only) **See next page**
4. Keypad (optional accessory)

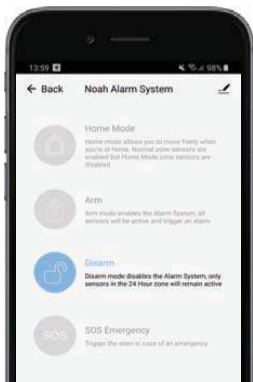

How to use the Noah hub

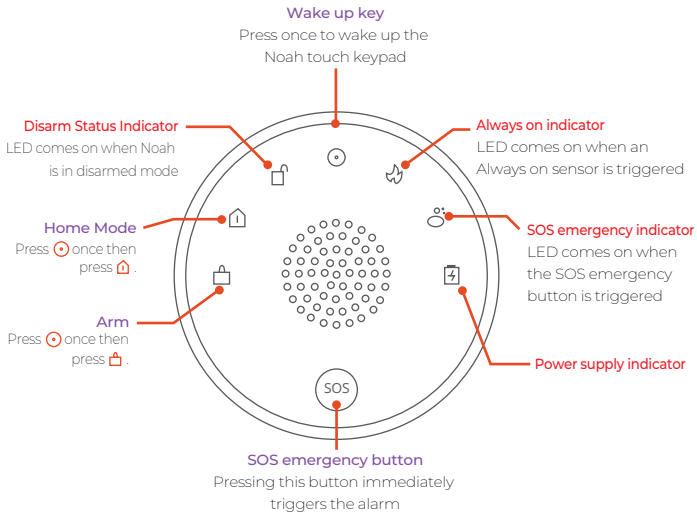

LED light colours



Solid Green

Noah is disarmed



Solid Blue

Noah is armed



Solid Red

Alarm has been triggered



Solid Purple

Ready to pair with accessories

Installing Noah hub on a wall

The Noah hub can be placed on a table or installed on a wall. To use the Noah hub touch keypad to arm Noah, we recommend positioning it near the door most frequently used to enter and exit your home. Additional remote controls and keypads are available to purchase.

To install the Noah hub on a wall, follow the steps below:

1. Remove the back cover from the Noah hub by rotating it anti-clockwise
2. Secure the back cover on to the wall using the provided screws and screw plugs (if required)
3. Ensure the on/off switch on the back of the Noah hub is switched on, then fix the hub on to the back cover
4. Connect the Noah hub to a mains power supply using the provided micro USB cable and adapter

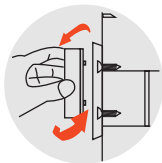
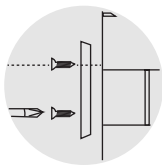
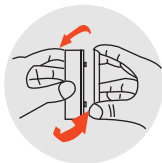

Adding sensors

There are 3 steps to adding your door/window & motion sensors to the Noah Alarm System:



To make the setup process easier, complete steps 1, 2 and 3 for each sensor before moving on to the next one

Other optional accessories include:

Door/Window sensor with motion sensor

Door/Window sensor with vibration sensor

Smoke detector

Gas leak detector

Water leak detector

Keypad

Additional remote controls

Indoor Siren

Outdoor Siren

RF Repeater

For pairing of additional accessories, please see setup guide included with accessories.

Step 1 – Pair sensors

Sensors that are included with the Noah Alarm System are already paired with the Noah hub. Move on to Step 2: Configure sensors



Select the  Accessories icon on the dashboard to enter the Accessories menu and view paired sensors

To activate each sensor, simply remove the back cover and pull out the battery tabs, then replace the cover securely

You are able to pair up to 40 additional sensors to the Noah Alarm System.

To pair additional sensors, please ensure Noah is in **disarm mode** 

Paired sensors will automatically appear in the Accessories menu in the app.

Select the  Accessories icon on the dashboard to enter the Accessories menu, then follow the steps below:



Step 1

Remove the back cover from the sensor and pull out the battery tabs. Then replace the cover



Step 2

Press the (+Add) icon. The Noah hub LED will turn purple when it is ready for pairing. It will remain in pairing mode for 30 seconds.

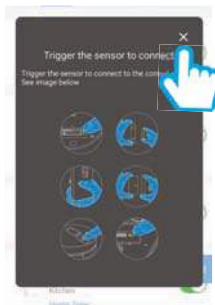

Step 3

Trigger sensor (see image below)

The Noah hub LED will flash green when the sensor has been paired successfully.

Press the “x” icon once the sensor has paired.
Paired sensors will automatically appear in the Accessories menu in the app

How to trigger different accessories



Step 2 – Configure sensors

Select the  Accessories icon on the dashboard to enter the Accessories menu.

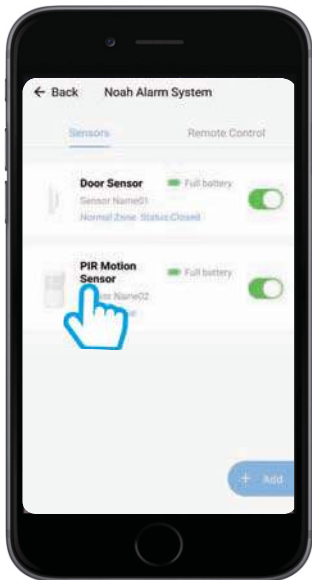

You are able to enable and disable accessories from this page. We recommend that you give each accessory a unique name so it is easier to recognise the location should an alarm be triggered.

You can also assign each sensor to a Zone Type (see page 25) To configure any accessory, simply press the accessory name.

On this page, you can customise the accessory name, select the zone type and also delete the accessory from the app, if required.

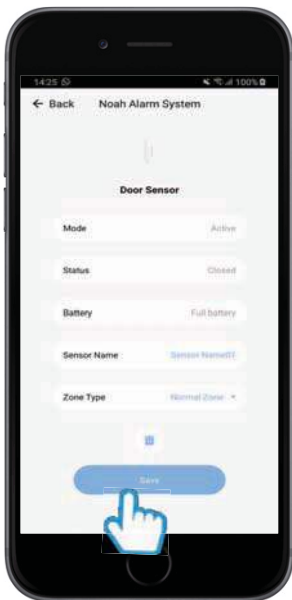

Manage Zones

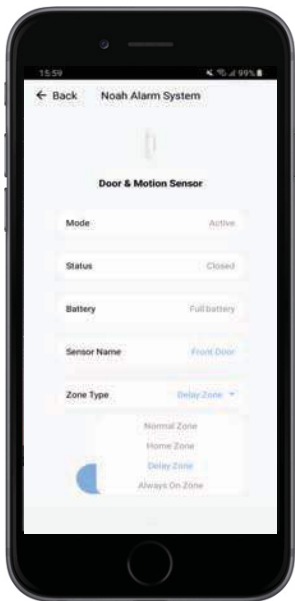

Normal Zone

Sensors in this zone activate an alarm immediately after being triggered



Home Zone

Sensors in this zone are disabled when Noah is in Home Mode, allowing you to move freely around your home without triggering the alarm



Delay Zone

Sensors in this zone allow a delay for entry/exit before the alarm is triggered. The delay duration can be adjusted in the settings (See page 28)



Always On Zone

Sensors in this zone are always active, no matter what mode Noah is in. An immediate alarm is activated if the sensors are triggered e.g. smoke alarm, water sensor or security doors

Step 3 – Install sensors

Installing the Door/Window Sensor

1. Open the back cover of the sensor and check the battery is fitted properly
2. Ensure the area that the sensor will be located is clean and free from dust and moisture. Avoid mounting the sensor in areas with lots of metal or electrical wiring
3. Use the adhesive strip to carefully mount the sensor on to the door/window frame
4. Mount the magnet on to the door/window, no more than 1cm from the sensor

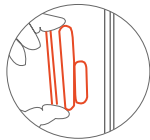
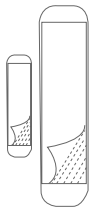
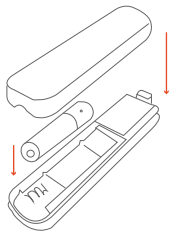

Installing the Motion Sensor

1. Open the back cover by pressing down on the clip at the top. Check that the battery is fitted properly
2. Place the cover back on close tightly. Secure with provided security screw
3. Use the provided screws to fix the bracket on the wall, then attach the sensor to the bracket.
Ensure it is fitted around 2 metres from the ground, then adjust the angle of the sensor to the best suited position

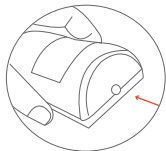
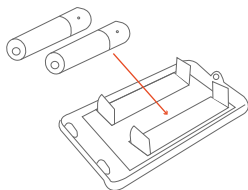

Detection area

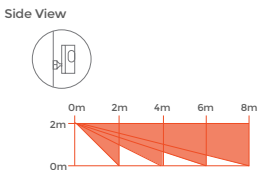
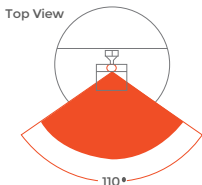

Walk test: Walk across the detection area and watch the LED indicator - it will flash once when movement is detected. The sensors will detect movement once a minute.

Settings

Select the  Setting icon on the dashboard to enter Noahs settings

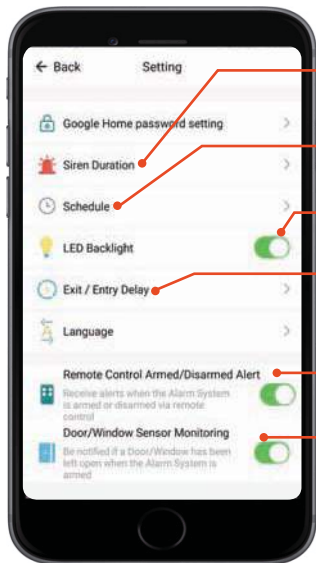

Set the siren duration from 1 to 300 seconds
Choosing 0s will mute the siren

Schedule when to arm or disarm Noah.
Time tolerance may be +/- 30 seconds

Turn Noah's LED backlight on or off

Set an exit and entry delay of up to 300
seconds for sensors in the delay zone, giving
you time to enter or leave your home without
triggering the alarm

Receive smartphone alerts that tell you whose
remote control has armed or disarmed Noah

Receive smartphone alerts that tell you if a
window or door has been left open when
Noah is armed

Be a part of Clan

Are you on Facebook? Join our Clan to speak to other members of the Clan and our dedicated UK based support team:

www.facebook.com/groups/partoftheclan

Need further Help?

Contact our Customer Support team on Social Media



facebook.com/time2HQ



m.me/time2HQ



[@time2HQ](https://twitter.com/time2HQ)

or visit our support page

time2technology.com/support