



Ella

Start Up Guide

Protect and monitor
the things you love

Contents

1 Get Started

2 Download App

3 Register

5 Add Ella - Bluetooth (Recommended)

7 Add Ella - WiFi

10 Features

11 Timer & Schedule

12 Reset Ella

Struggling to read?

View this start up guide online at
time2technology.com/manuals

Get Started

Screw Ella in to the light fitting and turn on the light switch. Ella will begin flashing quickly.

If Ella is not flashing quickly, please follow the reset instructions on Page 10

What do the flashing lights mean?



Quick Flashing
Ready to connect
via Bluetooth and
WiFi mode

Download App

Download the "Clan at home" app from the iOS App Store or Google Play Store

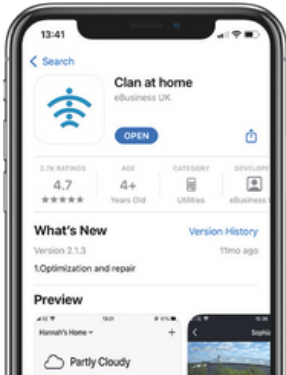
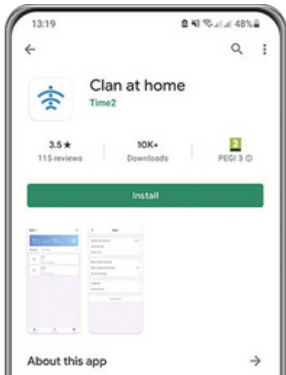

Register

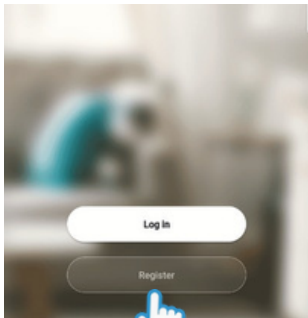

Step 1

Open the app then press
"Register"

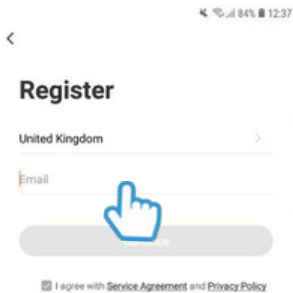

Step 2

Enter your email address

Register



Verification Code

Verification code has been sent to: 0123456789 , Resend (52s)

Step 3

Enter the verification code sent via email



Set Password

Password must contain 6-20 letters and numbers

Done



Step 4

Create your password to login

Add Ella - Bluetooth

Note: Ensure both Bluetooth and WiFi are enabled.

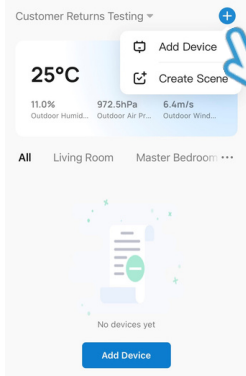

Step 1

In My Home, click the (+) icon in the top right-hand corner of the screen, then click "Add Device".

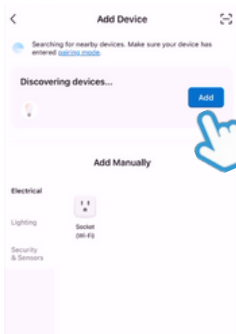

Step 2

Ella will then appear in the discovering devices tab. Click "Add".

Add Ella - Bluetooth

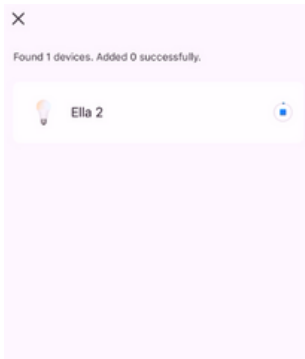

Step 3

Ella will now begin to pair with
Clan, this can take up to 2
6 minutes.



Step 4

When Ella has
successfully paired press,
"Next". Then "Done"
on the following screen.

Add Ella - WiFi

Note: To pair via WiFi, please disable Bluetooth.

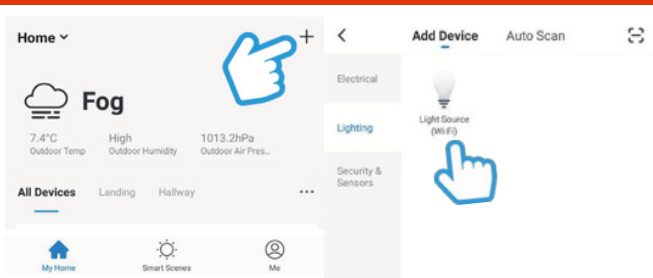

Step 1

In My Home, click the (+) icon in the top right-hand corner of the screen, then click "Add device".

7

Step 2

Select "Lighting Devices".

Add Ella - WiFi

Select 2.4 GHz Wi-Fi Network and enter password.

If your Wi-Fi is 5GHz, please set it to be 2.4GHz.
[Common router setting method](#)



Step 3

Enter your WiFi
router password.

Then press "Next"



Cancel

EZ Mode >>

The LED Indicator light

If the indicator is already blinking or breathing, please skip the reset step:
Turn the device on, off, on, off, and on until the indicator blinks or breathes (the user manual prevails).



Perform net pairing as prompted. >

- Confirm the indicator is blinking or breathing rapidly



Step 4

Confirm the is
blinking rapidly.

Then Press "Next"



Add Ella - WiFi

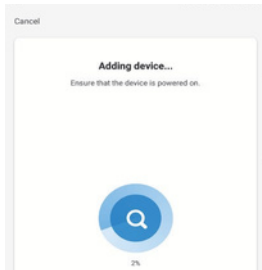

Step 5

Ella will then establish a connection to Clan

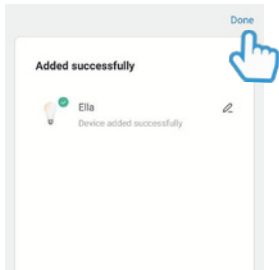

Step 6

Once connected you can change Ella's name and select the room it's in.

Press "Done"

Features

Set a scene for the bulbs or create your own personal scene

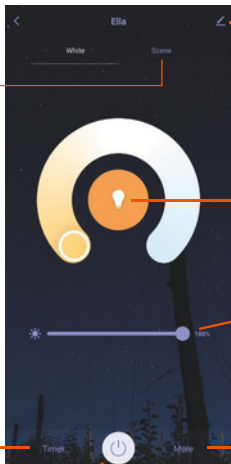

Bulb settings

Adjust the warmth of the bulb from warm white to cool white

Control brightness

Set timer

Set schedules or use the biorhythm feature to customise bulb usage according to your needs

Simply tap on the on-screen button to turn Ella on and off

Timer & Schedule

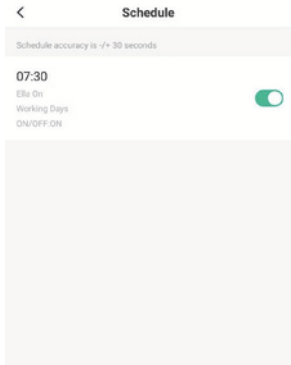
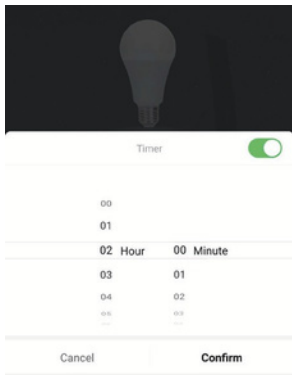

To add a schedule, simply set the time and day you would like Ella to come on and turn off automatically.

Reset Ella

If you are having trouble connecting to Ella, you may need to do a reset.

How to reset Ella?

Turn the power to the bulb off and on 3 times quickly.

(Allow the light to turn on before turning back off each time.

i.e. off-on-off-on-off-on)

The bulb will begin flashing quickly when it is ready for setup.



Be a part of Clan

Are you on Facebook? Join our Clan to speak to other members of the Clan and our dedicated UK based support team:

www.facebook.com/groups/partoftheclan

Need further Help?

Contact our Customer Support team on Social Media



facebook.com/time2HQ



m.me/time2HQ



[@time2HQ](https://twitter.com/time2HQ)

or visit our support page

time2technology.com/support