



# Ella

---

Start Up Guide  
Protect and monitor the  
things you love

# Contents

- 2 Contents
- 3 Get Started
- 4 Download App
- 5 Register
- 6 Add Ella - using WIFI Mode
- 9 Add Ella - using AP Mode
- 14 Features
- 15 Timer & Schedule
- 16 Reset Ella
- 17 Be a part of Clan

**Struggling to read?**

View this start up guide online at  
**[time2technology.com/manuals](http://time2technology.com/manuals)**

# Get Started

Screw Ella in and turn on the light switch.

Ella will start flashing quickly.

If Ella is not flashing quickly, please follow instructions on page 16 to reset the bulb



**What do the flashing lights mean?**



**Quick Flashing**

Ready to connect via WIFI Mode



**Slow Flashing**

Ready to connect via AP Mode

# Download App

Download the “Clan at home” App on the iOS App Store or Google Play Store.

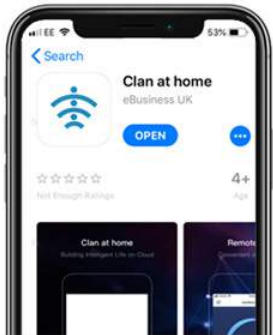
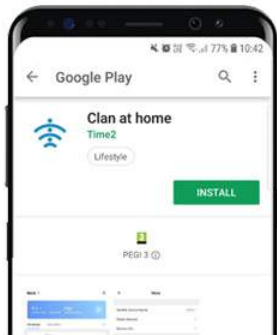

# Register

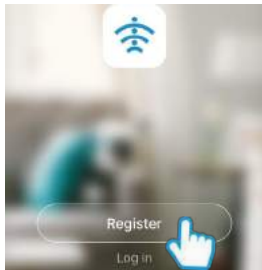

## Step 1

Open the app then select Register



## Register

United Kingdom +44



07463 569 176

Continue



## Step 2

Enter your mobile phone number  
or email address

**Please ensure you enter your full  
phone number including "0"**

# Add Ella - using WIFI Mode

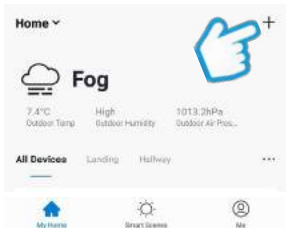

## Step 1

In My Home, click the (+) icon in the top right-hand corner of the screen



## Step 2

Select Lighting Devices

# Add Ella - using WIFI Mode

Power on the device and confirm that indicator light rapidly blinks



[View Help](#)

Confirm indicator rapidly blink



## Step 3

Make sure the bulb is flashing white quickly. (If it is not flashing, see the reset instructions on page 16)

Select Confirm indicator rapidly blink

## Enter Wi-Fi Password

Please note: most Wi-Fi routers provide 2.4GHz and 5GHz frequency channels. This app will only work on 2.4GHz frequency and will usually be automatically selected. If you have difficulty in connecting to your Wi-Fi, please check with your broadband provider.



Your WiFi

[Change Network](#)

Confirm



## Step 4

Enter your WiFi router password

Then press Confirm

# Add Ella - using WIFI Mode

## Connecting Now

Ensure that your Phone and Device are as close to your WIFI router as possible.



- Searching for Device
- Registering device to the cloud
- Initializing your Device

### Step 5

Ella will then establish a connection to Clan

## Device added successfully



Living Room

Bedroom

Second Bedroom

Dining Room

Kitchen

Study Room



Done

### Step 6

Once connected you can change Ella's name and select the room it's in.

Press Done



# Add Ella - using AP Mode



## Step 1

In My Home, click the (+) icon in the top right-hand corner of the screen

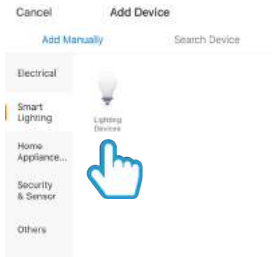

## Step 2

Select Lighting Devices

# Add Ella - using AP Mode

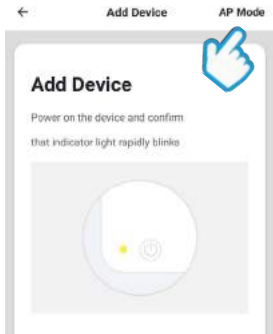

## Step 3

Select AP Mode in the top right-hand corner of the screen



## Step 4

Turn the power to the bulb off and on 3 times quickly. (Allow the light to turn on before turning back off each time. i.e. off-on-off-on-off-on)

The bulb will begin flashing slowly when it is in AP Mode

# Add Ella - using AP Mode

## Add Device

Power on the device and confirm that indicator light slowly blinks



View Help

Confirm indicator slowly blink

### Step 5

Press Confirm indicator slowly blink

## Enter Wi-Fi Password

Please note: most Wi-Fi routers provide 2.4GHz and 5GHz frequency channels. This app will only work on 2.4GHz frequency and will usually be automatically selected. If you have difficulty in connecting to your Wi-Fi, please check with your broadband provider.



Your WIFI



Change Network

Confirm

### Step 6

Enter your WiFi router password  
Then press Confirm

# Add Ella - using AP Mode

## Connect phone to device's wifi hotspot

1. Open WLAN Settings



2. Back to the App and continue to add device



Go connect

### Step 7

Press Go Connect



### Step 8

Connect to SmartLife-XXXX network then click back

# Add Ella - using AP Mode

## Connecting Now

Ensure that your Phone and Device are as close to your WIFI router as possible.



- Searching for Device
- Registering device to the cloud
- Initializing your Device

### Step 9

Ella will then establish a connection to Clan

## Device added successfully



### Step 10

Once connected you can change Ella's name and select the room it's in.

Press Done

# Features

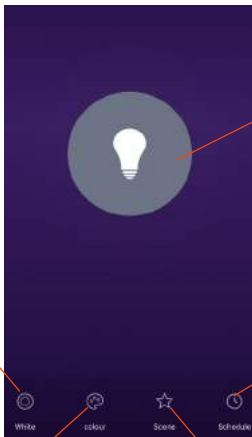

Simply tap on the on-screen button to turn Ella on and off

Adjust the warmth of the bulb from cool white to warm white

Schedule when you would like Ella to come on and turn off automatically

Change bulb colour. Choose from over 16 million colours!

Set a scene for the bulbs or create your own personal scene

# Timer & Schedule

<	Add Schedule	Save
	10 49	
	11 50	
	12 51	
	<b>13 52</b>	
	14 53	
	15 54	
	16 55	
Repeat		Never >
Switch		ON >

<	Add Schedule
Schedule accuracy is +/- 30 seconds	
07:45	
Working Day	
Switch On	

To add a schedule, simply set the time and day you would like Ella to come on and turn off automatically

# Reset Ella

If you are having trouble connecting to Ella, you may need to do a reset.

## How to reset Ella

Turn the power to the bulb off and on 3 times quickly.

(Allow the light to turn on before turning back off each time. i.e. off-on-off-on-off-on)

The bulb will begin flashing quickly when it is ready for setup.





# Be a part of Clan

Are you on Facebook? Join our Clan to speak to other members of the Clan and our dedicated UK based support team:

[www.facebook.com/groups/partoftheclan](http://www.facebook.com/groups/partoftheclan)

## Need further Help?

Contact our Customer Support team on Social Media



[facebook.com/time2HQ](https://www.facebook.com/time2HQ)



[m.me/time2HQ](https://m.me/time2HQ)



[@time2HQ](https://twitter.com/time2HQ)

or visit our support page

[\*\*time2technology.com/support\*\*](http://time2technology.com/support)