



Arthur

Start Up Guide
Protect and monitor the
things you love

Contents

- 2 Contents
- 3 Get Started
- 4 Download App
- 5 Register
- 6 Add Arthur - using WIFI Mode
- 9 Add Arthur - using AP Mode
- 14 Features
- 15 Timer & Schedule
- 16 Reset Arthur
- 17 Be a part of Clan

Struggling to read?

View this start up guide online at
time2technology.com/manuals

Get Started

Plug Arthur into a mains socket.

The red LED lights will come on and flash quickly



What do the flashing lights mean?



Solid Red
Starting up



Flashing Red
Ready to connect



Solid Blue
Connected

Download App

Download the “Clan at home” App on the iOS App Store or Google Play Store.

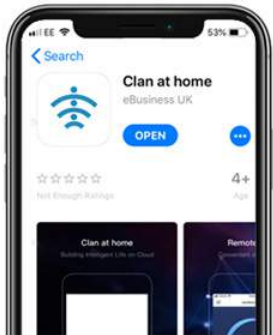
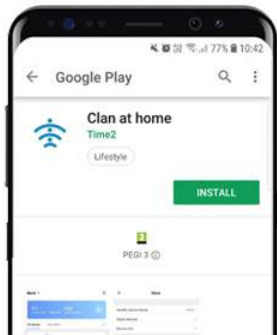

Register

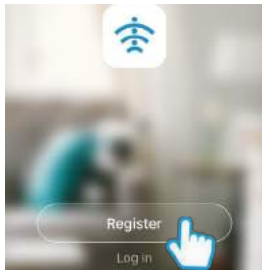

Step 1

Open the app then select Register



Register

United Kingdom +44



07463 569 176

Continue



Step 2

Enter your mobile phone number
or email address

**Please ensure you enter your full
phone number including "0"**

Add Arthur - using WIFI Mode

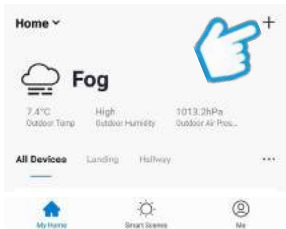

Step 1

In My Home, click the (+) icon in the top right-hand corner of the screen



Step 2

Select Electrical Outlet

Power on the device and confirm that indicator light rapidly blinks



[View Help](#)

Confirm indicator rapidly blink



Step 3

Make sure the device is flashing red.
(If it is not flashing, see the reset instructions on page 16)

Select Confirm indicator rapidly blink

Enter Wi-Fi Password

Please note: most Wi-Fi routers provide 2.4GHz and 5GHz frequency channels. This app will only work on 2.4GHz frequency and will usually be automatically selected. If you have difficulty in connecting to your Wi-Fi, please check with your broadband provider.



Your WiFi

[Change Network](#)

Confirm



Step 4

Enter your WiFi router password

Then press Confirm

Add Arthur - using WIFI Mode

Connecting Now

Ensure that your Phone and Device are as close to your WIFI router as possible.



- 1. Connecting to network
- 2. Registering device to the cloud
- 3. Initializing your Device

Step 5

Arthur will then establish a connection to Clan

Device added successfully



Main Office



Done

Step 6

Once connected you can change Arthur's name and select the room it's in.

Press Done

Add Arthur - using AP Mode



Step 1

In My Home, click the (+) icon in the top right-hand corner of the screen

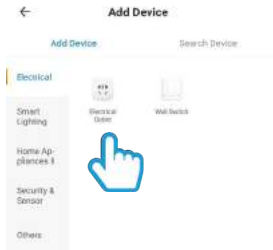

Step 2

Select Electrical Outlet

Add Arthur - using AP Mode

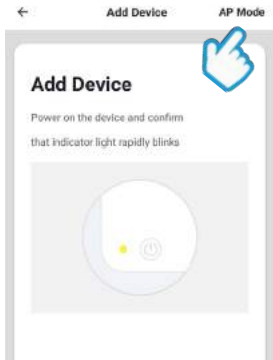

Step 3

Select AP Mode in the top right-hand corner of the screen



Step 4

Press the power button down on Arthur. Keep it pressed until the LED flashes red slowly

Add Arthur - using AP Mode

Add Device

Power on the device and confirm that indicator light slowly blinks



View Help

Confirm indicator slowly blink

Step 5

Press Confirm indicator slowly blink

Enter Wi-Fi Password

Please note: most Wi-Fi routers provide 2.4GHz and 5GHz frequency channels. This app will only work on 2.4GHz frequency and will usually be automatically selected. If you have difficulty in connecting to your Wi-Fi, please check with your broadband provider.



Your WIFI



Change Network

Confirm

Step 6

Enter your WiFi router password
Then press Confirm

Add Arthur - using AP Mode

Connect phone to device's wifi hotspot

1. Open WLAN Settings



2. Back to the App and continue to add device



Step 7

Press Go Connect



Step 8

Connect to SmartLife-XXXX network then click back

Add Arthur - using AP Mode

Connecting Now

Ensure that your Phone and Device are as close to your WIFI router as possible.



- Searching for Device
- Registering device to the cloud
- Initializing your Device

Step 9

Arthur will then establish a connection to Clan

Device added successfully



Main Office



Done

Step 10

Once connected you can change Arthur's name and select the room it's in.

Press Done

Features

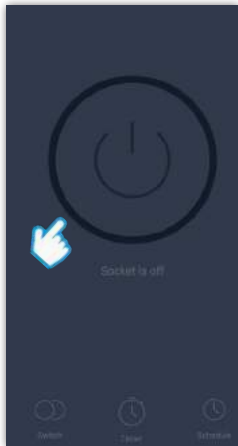
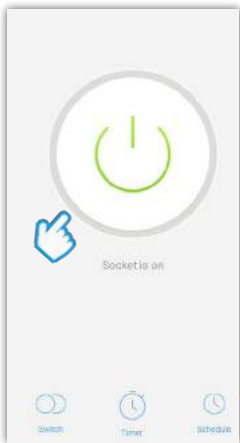

Simply tap on the on-screen button to turn the socket on and off

Timer & Schedule



Use the timer feature to automate when Arthur comes on or turns off

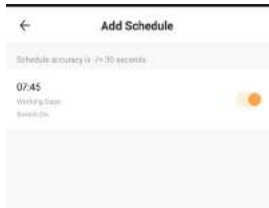
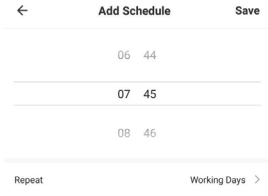

To add a schedule, simply set the time and day you would like Arthur to come on and turn off automatically

Reset Arthur

If you are having trouble connecting to Arthur, you may need to do a reset.

How to reset Arthur

Press and hold down the power button at the front of the socket.

The LED will begin flashing red when it is ready for setup.



Be a part of Clan

Are you on Facebook? Join our Clan to speak to other members of the Clan and our dedicated UK based support team:

www.facebook.com/groups/partoftheclan

Need further Help?

Contact our Customer Support team on Social Media



[facebook.com/time2HQ](https://www.facebook.com/time2HQ)



m.me/time2HQ



[@time2HQ](https://twitter.com/time2HQ)

or visit our support page

time2technology.com/support